

# MGP REAR SETS - HONDA CBR250R / CBR300R 2011-16

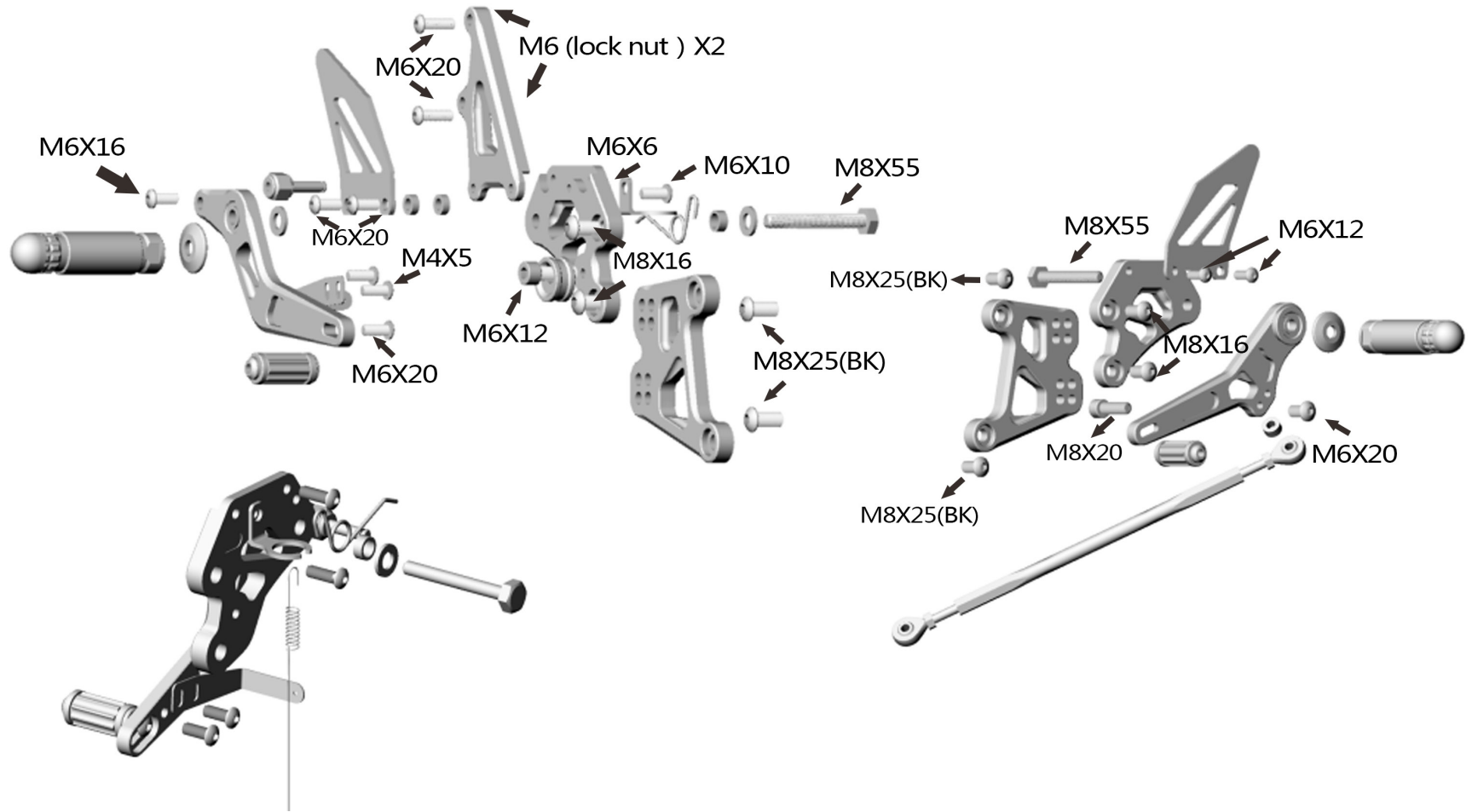

**! REMOVE PRE-ASSEMBLY O-RINGS BEFORE INSTALLING**

**! APPLY LOCKTIGHT TO ALL MOUNTING FASTENERS**



UNLESS OTHERWISE SPECIFIED, DIMENSIONS ARE IN INCHES .XX ± 0- .XXX ± 0.00- ANGULAR ± ° XXXX ± 0.000- FRACTIONAL ±		NAME	DATE	<b>MGP</b> <small>www.mgp.com</small>	
SURFACE FINISH ✓		DRAWN	Bruce B.		05/01/15
DO NOT SCALE DRAWING		CHECKED	Jeremy T.		05/02/15
BREAK ALL SHARP EDGES AND REMOVE BURRS		APPROVED	Roger D.		05/03/15
THIRD ANGLE PROJECTION				TITLE	
		MATERIAL	FINISH	HONDA CBR250R / CBR300R 2011-16 REAR SETS	
		ALUMINUM	ANODIZED	SIZE	
		DWG NO.		41102-2500	
		SCALE	WEIGHT	REV. B	
				SHEET 1 of 1	