

MGP REAR SETS - SUZUKI GSX-R 600/750 2006-16

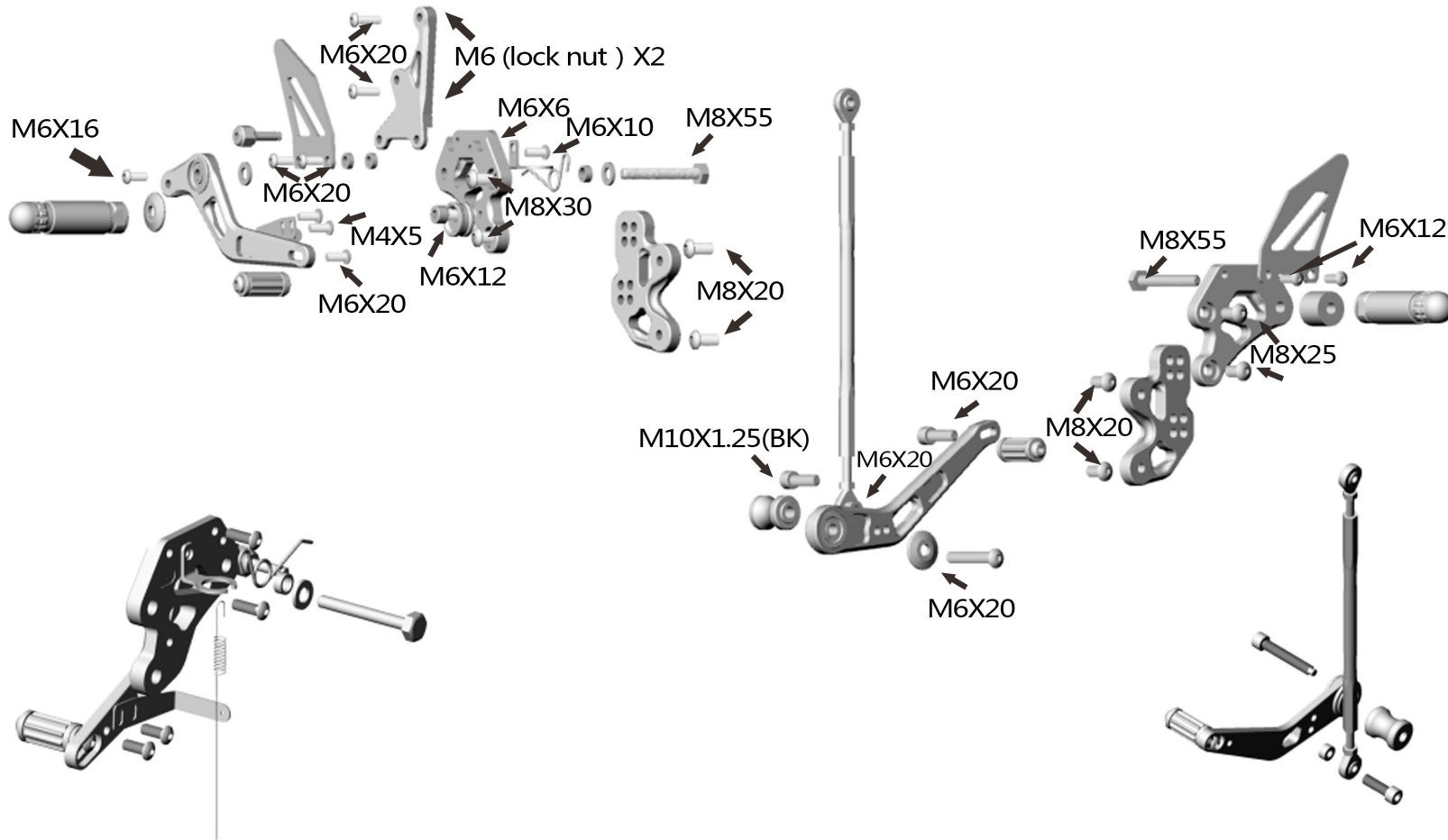

! REMOVE PRE-ASSEMBLY O-RINGS BEFORE INSTALLING

! APPLY LOCKTIGHT TO ALL MOUNTING FASTENERS

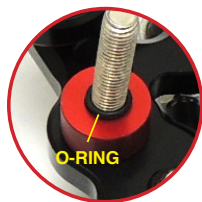

UNLESS OTHERWISE SPECIFIED, DIMENSIONS ARE IN INCHES .XX ± 0- .XXX ± 0.00- XXXX ± 0.000-		NAME	DATE	MGP <small>MOTORCYCLE MACHINERY</small>	
ANGULAR ± ° FRACTIONAL ± ±		DRAWN	Bruce B.		05/01/14
SURFACE FINISH ✓		CHECKED	Jeremy T.		05/02/14
DO NOT SCALE DRAWING		APPROVED	Roger D.		05/03/14
BREAK ALL SHARP EDGES AND REMOVE BURRS		TITLE			SUZUKI GSX-R 600/750 2006-16 REAR SETS
THIRD ANGLE PROJECTION		SIZE			
		MATERIAL	FINISH	DWG NO.	REV.
		ALUMINUM	ANODIZED	61101-2500	B
		SCALE	WEIGHT	SHEET	1 of 1